

RoHS

Specification

sfled1DF1A

sfleds		Customer
Drawn	Approval	Approval

[Contents]

- 1. Description**
- 2. Outline dimensions**
- 3. Characteristics of sfleds-1DF1A**
- 4. Characteristic diagrams**
- 5. Binning & Labeling**
- 6. Reel packing**
- 7. Recommended solder pad**
- 8. Reflow Soldering profile**
- 9. Precaution for use**
- 10. Revision history**

sfled1DF1A

Description

CUD1DF1A is a deep ultraviolet light emitting diode with peak emission wavelengths from 305nm to 315nm.

The LED is sealed in Ceramic packages with a choice of UV-transparent optical window.

It incorporates state of the art SMD design and low thermal resistance.

CUD1DF1A is designed for air and water sterilization and tools including chemical and biological analysis in that spectral range.



sfled1DF1A

Features

- Deep ultraviolet LED
- Low thermal resistance
- SMT solderable
- Lead Free product
- RoHS compliant

Applications

- Disinfection
- Fluorescent spectroscopy
- Chemical and Biological analysis

Outline dimensions

< Package Outline >

Top View

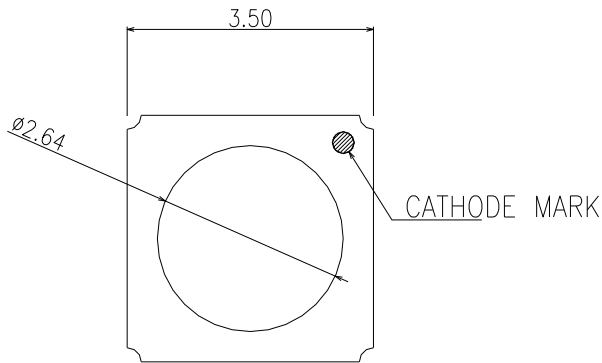

Bottom View

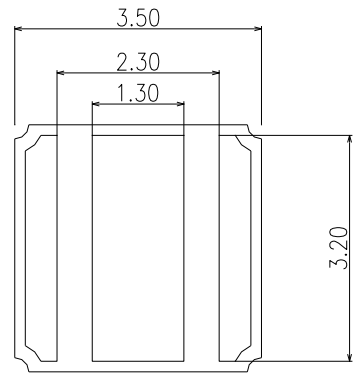

Side View

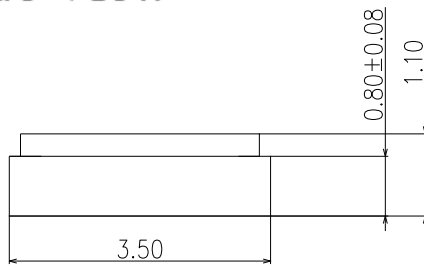

Circuit

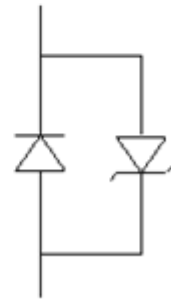

Notes :

- [1] All dimensions are in millimeters.
- [2] Scale : none
- [3] Undefined tolerance is ± 0.2 mm

Characteristics of sfled1DF1A

1. sfled1DF1A (310nm)

1-1 Electro-Optical characteristics at 20mA

(Ta=25°C, RH=30%)

Parameter	Symbol	Value	Unit
Peak wavelength ^[1]	λ_p	310	nm
Radiant Flux ^[2]	Φ_e ^[3]	1.3	mW
Forward Voltage ^[4]	V_F	6.0	V
Spectrum Half Width	$\Delta\lambda$	12	nm
View Angle	$2\theta_{1/2}$	130	deg.
Thermal resistance	$R\theta_{j-s}$	49.7	°C/W

1-2 Absolute Maximum Ratings

Parameter	Symbol	Value	Unit
Forward Current	I_F	30	mA
Power Dissipation	P_D	200	mW
Operating Temperature	T_{opr}	-30 ~ +60	°C
Storage Temperature	T_{stg}	-40 ~ +100	°C

Notes :

1. Peak Wavelength Measurement tolerance : $\pm 3\text{nm}$
2. Radiant Flux Measurement tolerance : $\pm 10\%$
3. Φ_e is the Total Radiant Flux as measured with an integrated sphere.
4. Forward Voltage Measurement tolerance : $\pm 3\%$

Characteristic Diagrams

1. Spectral Power Distribution

($I_F=20\text{mA}$, $T_a=25^\circ\text{C}$, $RH=30\%$)

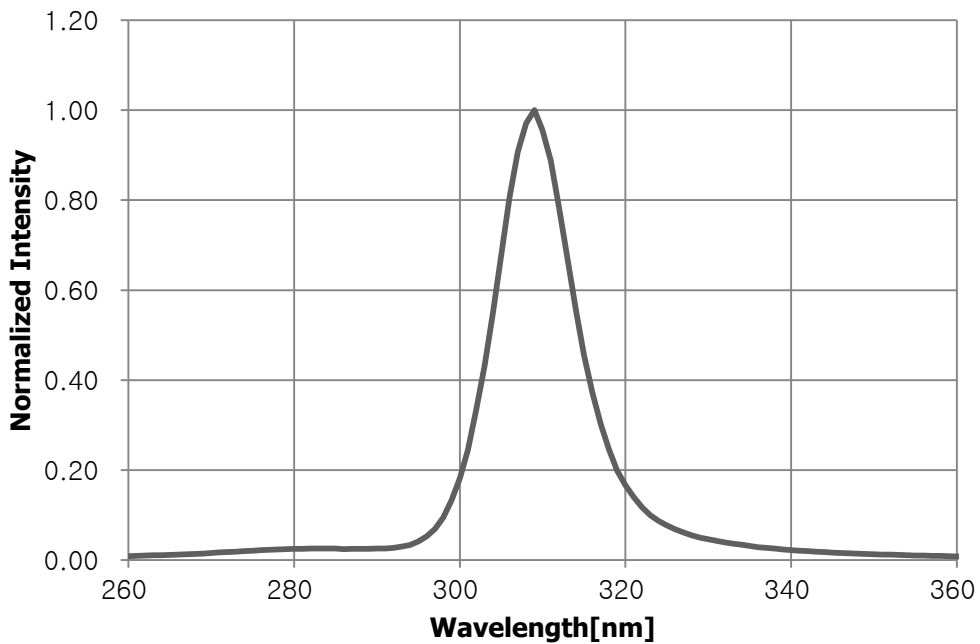

2. Forward current vs. Forward Voltage

($T_a=25^\circ\text{C}$)

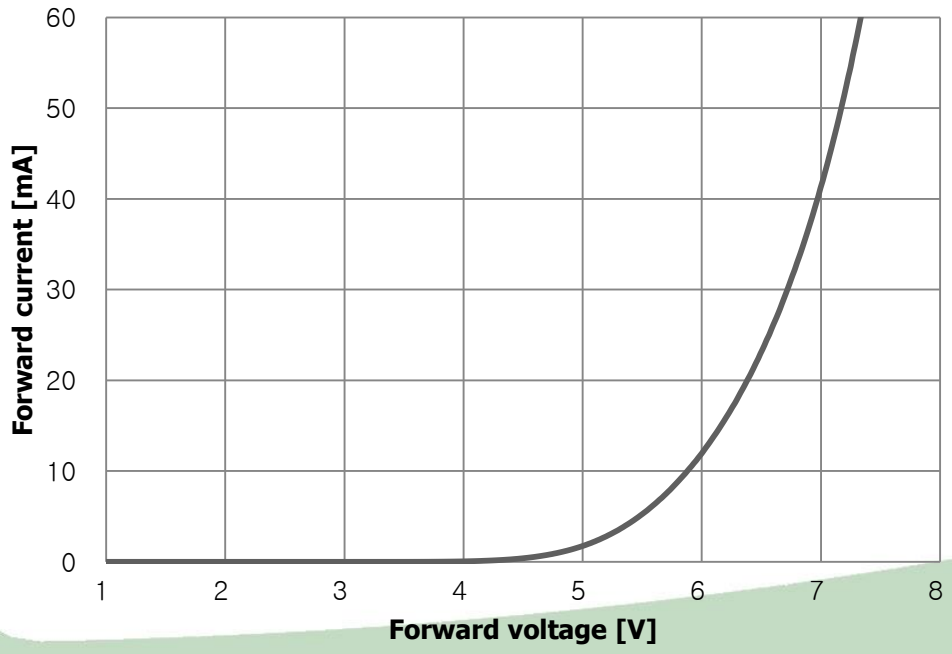

3. Relative Radiant Flux vs. Forward Current

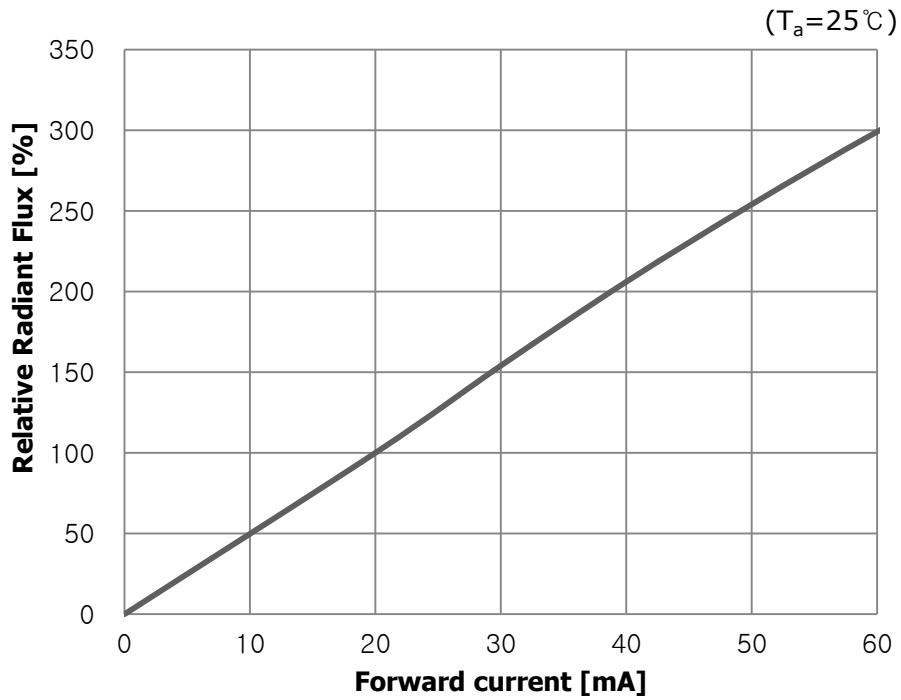

4. Peak Wavelength vs. Forward current

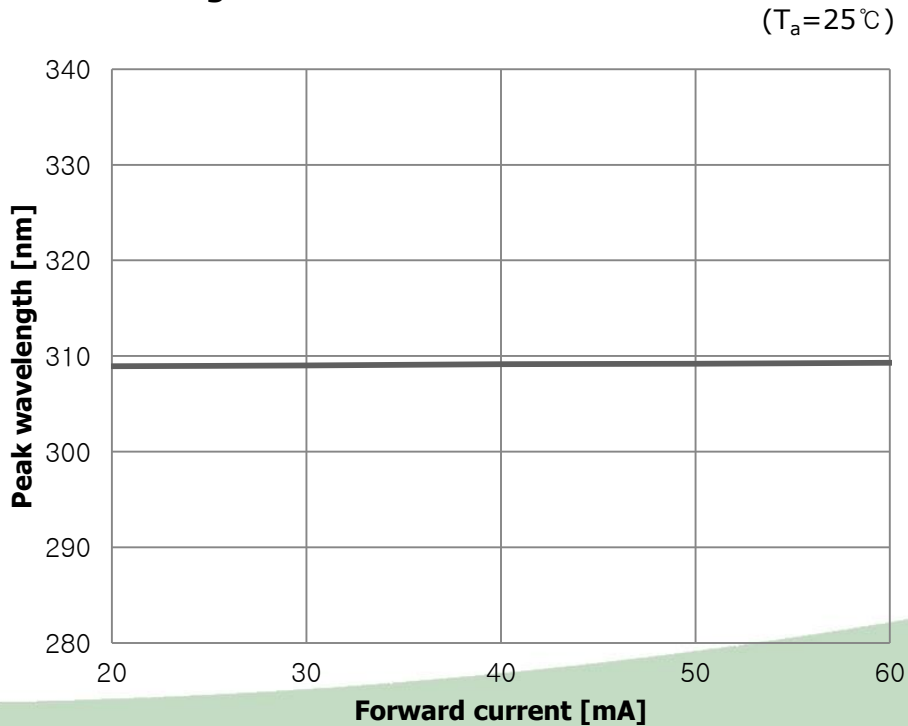

5. Relative Radiant Flux vs. Ambient Temperature

($I_F=20\text{mA}$)

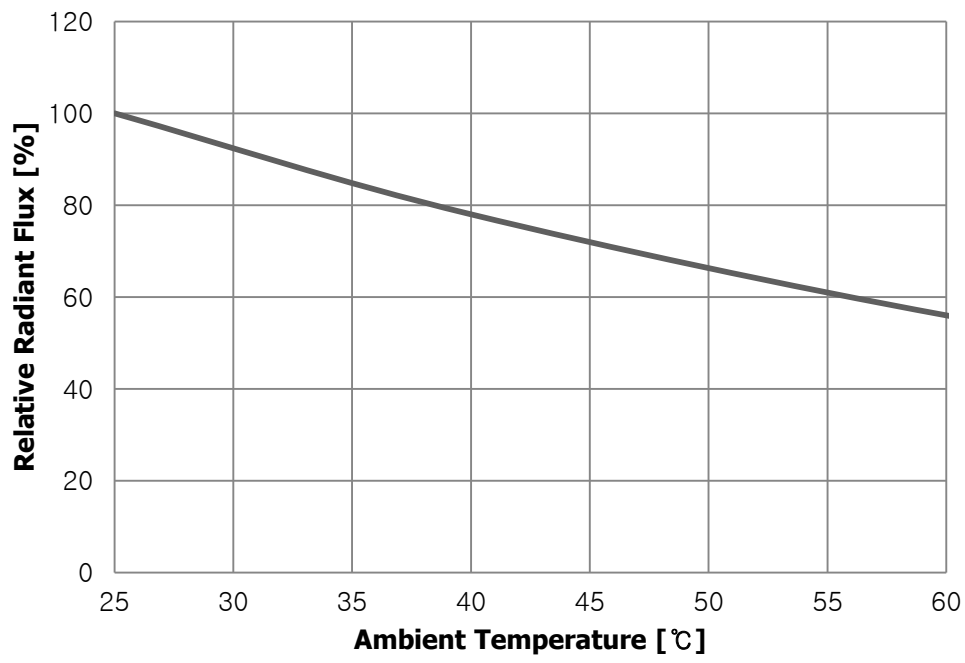

6. Peak Wavelength vs. Ambient Temperature

($I_F=20\text{mA}$)

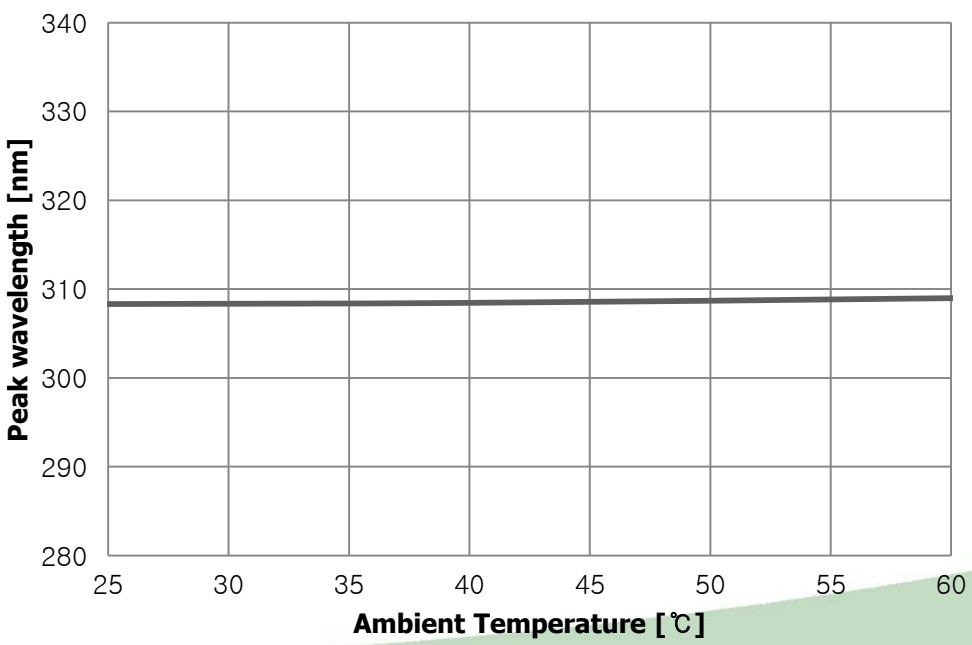

7. Forward Voltage vs. Ambient Temperature

($I_F=20\text{mA}$)

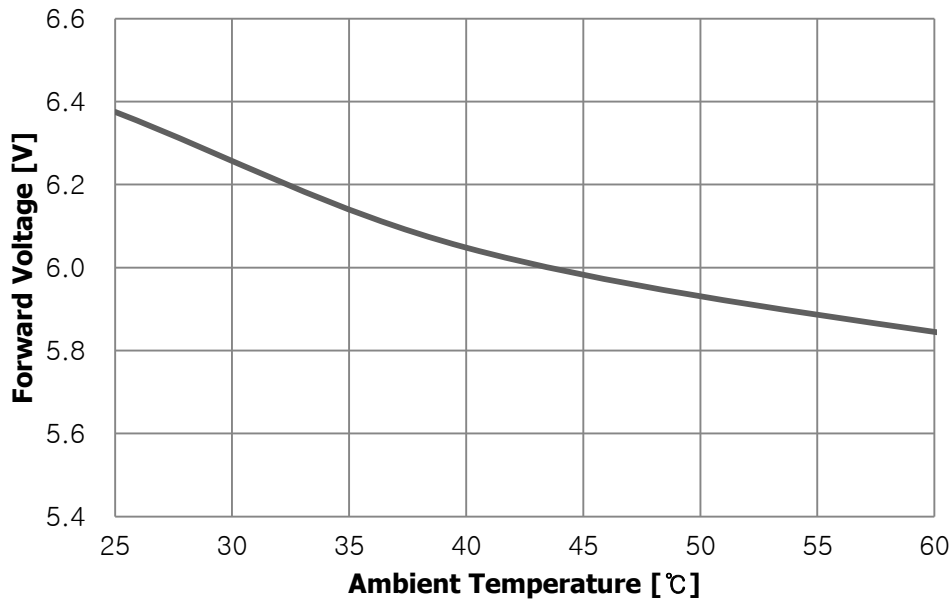

8. Radiant Pattern

($I_F=20\text{mA}$)

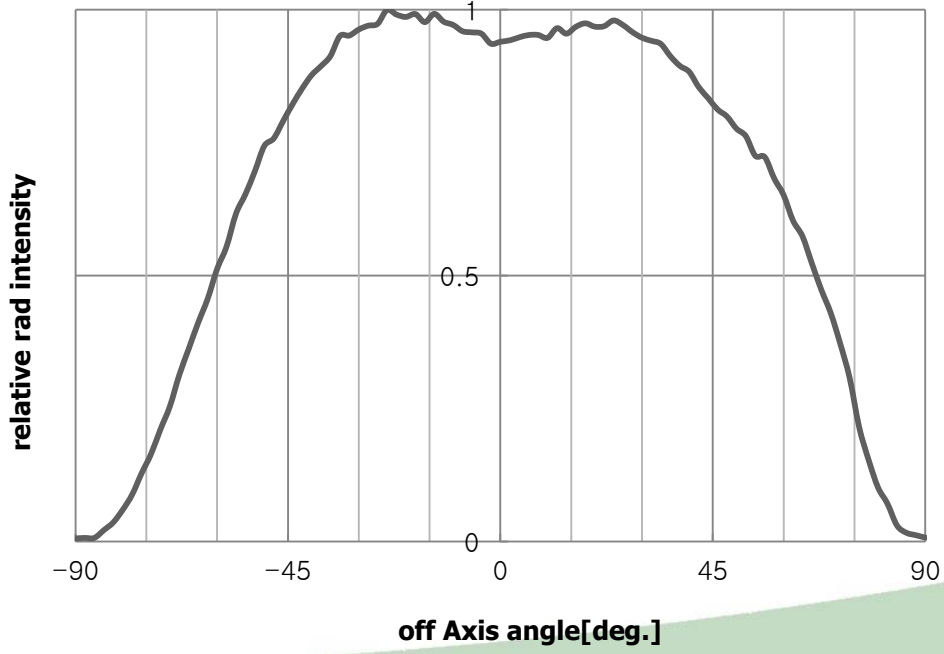

Shenzhen Shining Future LED Technology Co., Ltd.

Binning & Labeling

1. Binning Structure

Y₁Y₂Y₃Y₄Y₅

(I_F=20mA)

Part Number	Y ₁ Y ₂			Y ₃ Y ₄			Y ₅		
	Wp [nm]			Radiant Flux [mW]			Vf [V]		
	BIN	MIN	MAX	BIN	MIN	MAX	BIN	MIN	MAX
sfled1DF1A	c3	305	315	A1	0.4	0.7	a	5.0	5.2
				A2	0.7	1.0	b	5.2	5.4
				A3	1.0	1.3	c	5.4	5.6
				A4	1.3	1.6	d	5.6	5.8
				A5	1.6	1.9	e	5.8	6.0
				A6	1.9	2.2	f	6.0	6.2
				A7	2.2	2.5	g	6.2	6.4
							h	6.4	6.6
							i	6.6	6.8
							j	6.8	7.0

2. Rank

Y₁Y₂Y₃Y₄Y₅

- Y₁Y₂ : Peak Wavelength [nm]
- Y₃Y₄ : Radiant Flux [mW]
- Y₅ : Forward Voltage [V]

Notes :

1. Peak Wavelength Measurement tolerance : ±3nm
2. Radiant Flux Measurement tolerance : ± 10%
3. Forward Voltage Measurement tolerance : ±3%

X₁X₂X₃X₄X₅X₆X₇X₈

X ₁		X ₂		X ₃ X ₄		X ₅		X ₆		X ₇		X ₈	
Company		Product Line		Wavelength		PKG Series		Lens Type		Chip Q'ty		Ver	
sfleds	C	UV	U	Deep 310	D1	C3535	D	Flat	F	1	1	ver0	A

Reel Packaging

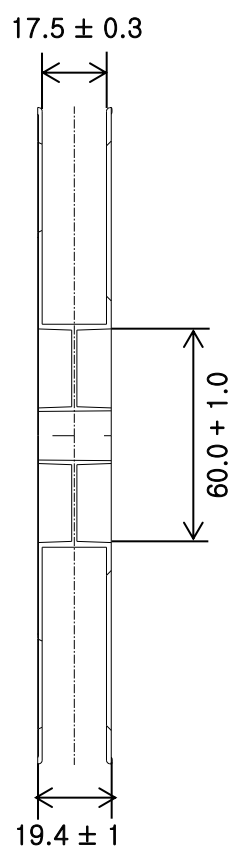
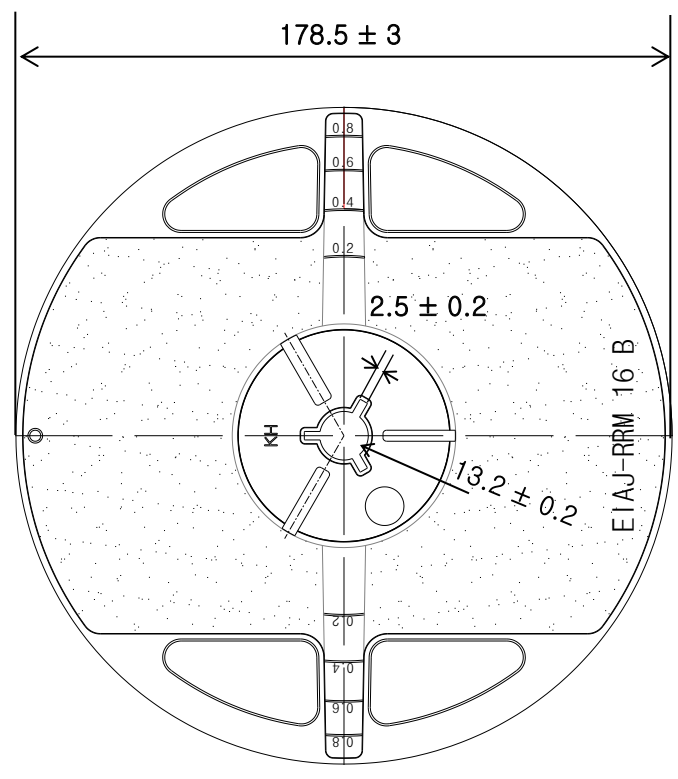
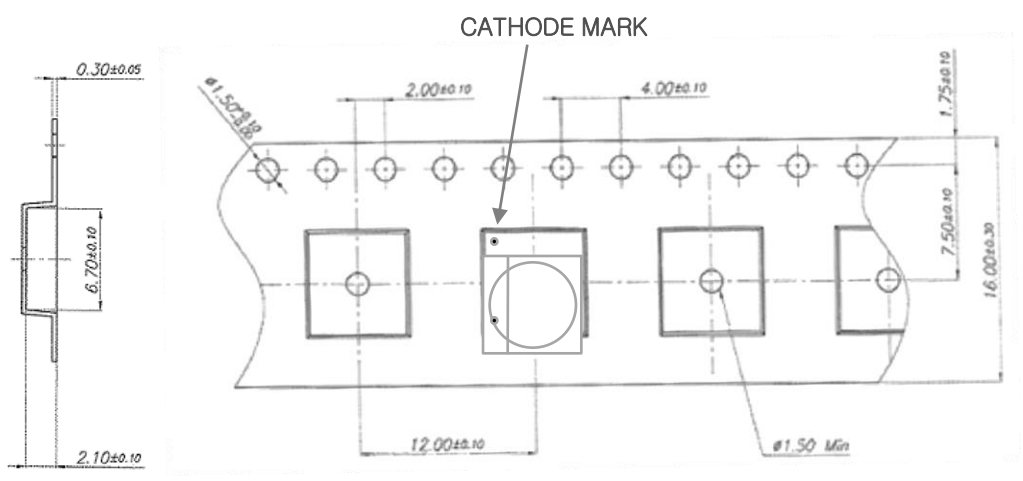

Recommended solder pad

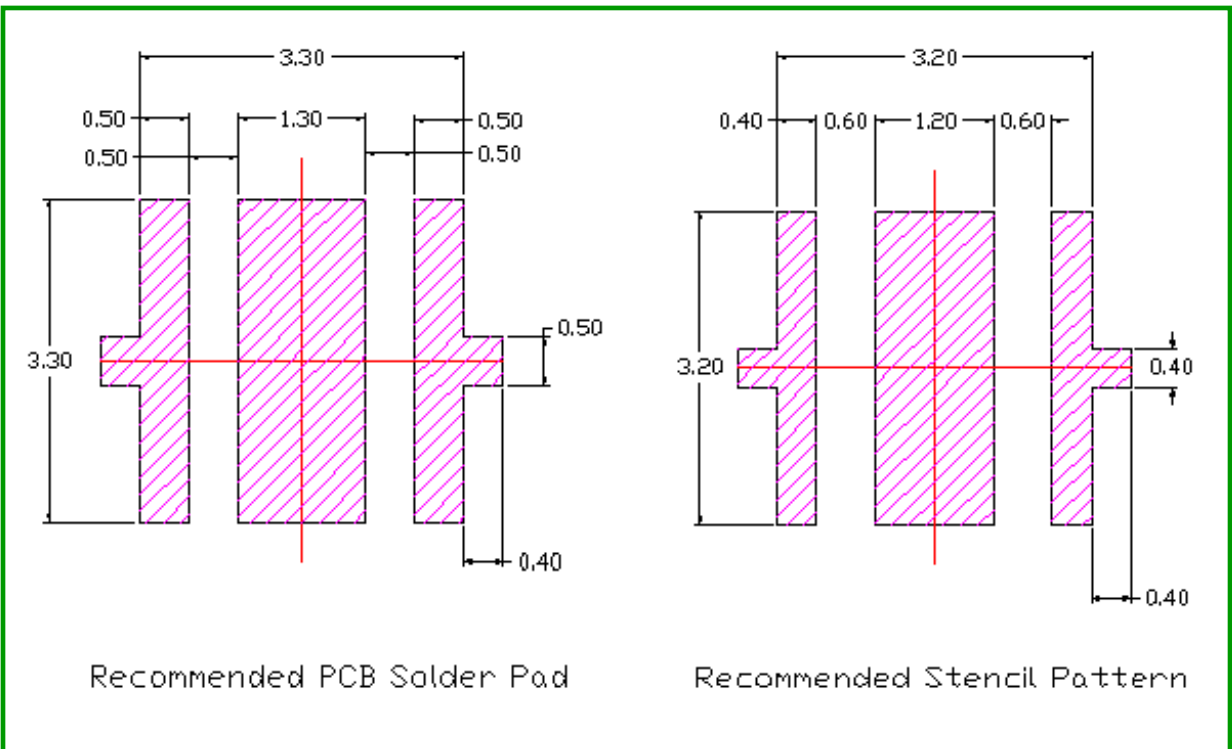

- Notes :
- [1] All dimensions are in millimeters.
 - [2] Scale : none
 - [3] This drawing without tolerances is for reference only

Reflow Soldering Profile

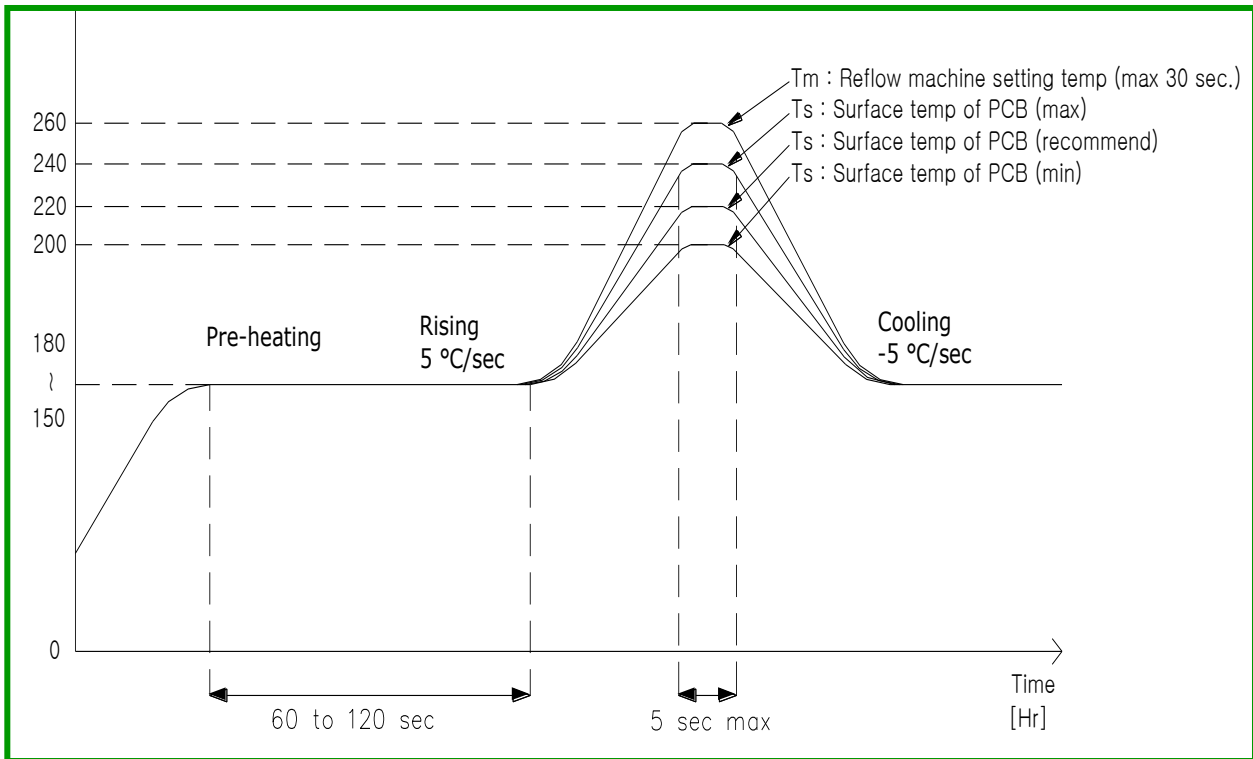

*** Caution**

1. Reflow soldering should not be done more than one time.
2. Repairs should not be done after the LEDs have been soldered. When repair is unavoidable, suitable tools must be used.
3. Die slug is to be soldered.
4. When soldering, do not put stress on the LEDs during heating.
5. After soldering, do not warp the circuit board.
6. Recommend to use a convection type reflow machine with 7 ~ 8 zones.

Precaution for use

1) Storage

- To avoid moisture penetration, we recommend storing UV LEDs in a dry box with a desiccant. The recommended temperature and Relative humidity are between 5°C and 30°C and below 50% respectively.
- more after being shipped from sfled, a sealed container with a nitrogen atmosphere should be used for storage.
- Replace the remained LEDs into the moisture-proof bag and reseal the bag after work to avoid those LEDs being exposed to moisture. Prolonged exposure to moisture can adversely affect the proper functioning of the LEDs.
- If the package has been opened more than 4 week(MSL_2a) or the color of the desiccant changes, components should be dried for 10-12hr at 60±5°C
- The conditions of resealing are as follows
 - Temperature is 5 to 40°C and Relative humidity is less than 30%

2) Handling Precautions

- VOCs (Volatile organic compounds) emitted from materials used in the construction of fixtures can penetrate silicone encapsulants of LEDs and discolor them when exposed to heat and photonic energy. The result can be a significant loss of light output from the fixture. Knowledge of the properties of the materials selected to be used in the construction of fixtures can help prevent these issues.
- In case of attaching LEDs, do not use adhesives that outgas organic vapor.
- Soldering should be done as soon as possible after opening the moisture-proof bag.
- Do not rapidly cool device after soldering.
- Do not apply mechanical force or excess vibration during the cooling process to normal temperature after soldering.
- Components should not be mounted on warped (non coplanar) portion of PCB.
- The optical window part of LED needs to be handled carefully as below
 - Avoid touching the optical window especially with sharp tools such as Pincettes (Tweezers)
 - Avoid leaving fingerprints on optical window parts.
 - Optical window will attract dust so use covered containers for storage.
 - When populating boards in SMT production, there are basically no restrictions regarding the form of the pick and place nozzle, except that excessive mechanical pressure on the surface of optical window parts must be prevented.
 - It is not recommend to cover the optical window of the LEDs with other resin (epoxy, urethane, etc)

Shenzhen Shining Future LED Technology Co.,Ltd.

3) Safety for eyes and skin



- The Products emit high intensity ultraviolet light which can make your eyes and skin harmful, So do not look directly into the UV light and wear protective equipment during operation.

4) Cleaning

- This device is not allowed to be used in any type of fluid such as water, oil, organic solvent , etc.

5) Others

- The appearance and specifications of the product may be modified for improvement without notice.
- When the LEDs are in operation the maximum current should be decided after measuring the package temperature.
- The driving circuit must be designed to allow forward voltage only when it is ON or OFF. If the reverse voltage is applied to LED, migration can be generated resulting in LED damage.
- Do not handle this product with acid or sulfur material in sealed space.

	 CAUTION
	<ul style="list-style-type: none"> •UV LEDs emit high intensity UV light. •Do not look directly into the UV light during operation. This can be harmful to your eyes and skin. •Wear protective eyewear to avoid exposure to UV light. •Attach caution labels to your products which contain UV LEDs. <p style="text-align: center;">Avoid direct eye and skin exposure to UV light. Keep out of reach of children.</p>

Shenzhen Shining Future LED Technology Co.,Ltd.

Revision history

No	Change Date	Change Issue	Version
1	2015.05.06	Initial specification	Rev 00